

Who we are

Sidapharm was founded in 2000 and is a manufacturer of a vast range of CE-certified ophthalmic products such as intraocular lenses, knives and cannulas, viscoelastics, BSS, cataract kits and ophthalmic instruments. Based in Thessaloniki, Greece, a city which connects Europe with Asia, Middle East and Africa. The company managed to take advantage of its location, expand its network and build strong collaborations through these continents.

Nowadays, Sidapharm has presence in more than 100 countries, mostly through very dynamic and reliable distributors. Our focus is on investing in long-lasting partnerships and assisting our distributors in every possible way to become more competitive and capture a bigger market share.



Intraocular Lenses

Preloaded

Hydrophobic Acrylic
Foldable Intraocular Lens

Orizon

PRELOADED

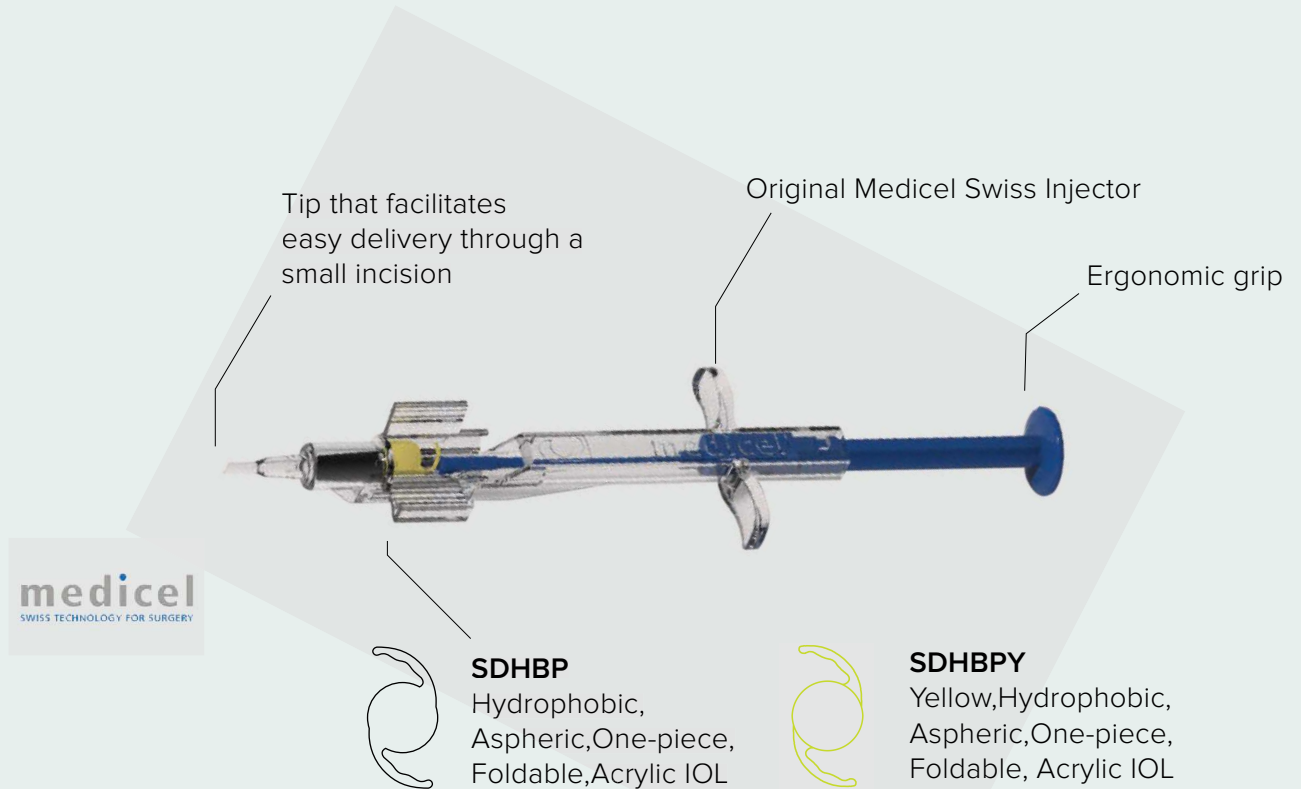

PREMIUM PRECISION

- Cast molding technology
- Superb quality of raw materials using pre-molded blanks
- Biocompatible hydrophobic acrylic material with UV absorption
- With Biconvex surfaces which minimize effects of tilt, decentration and aberration
- 360°square-edge profile for reduced PCO rates
- Notches for smooth manipulation

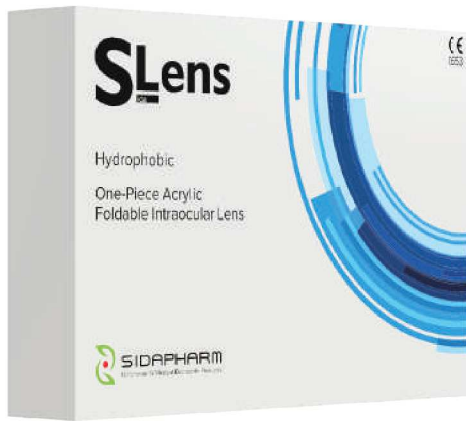

Hydrophobic One-Piece Acrylic Foldable Intraocular Lens

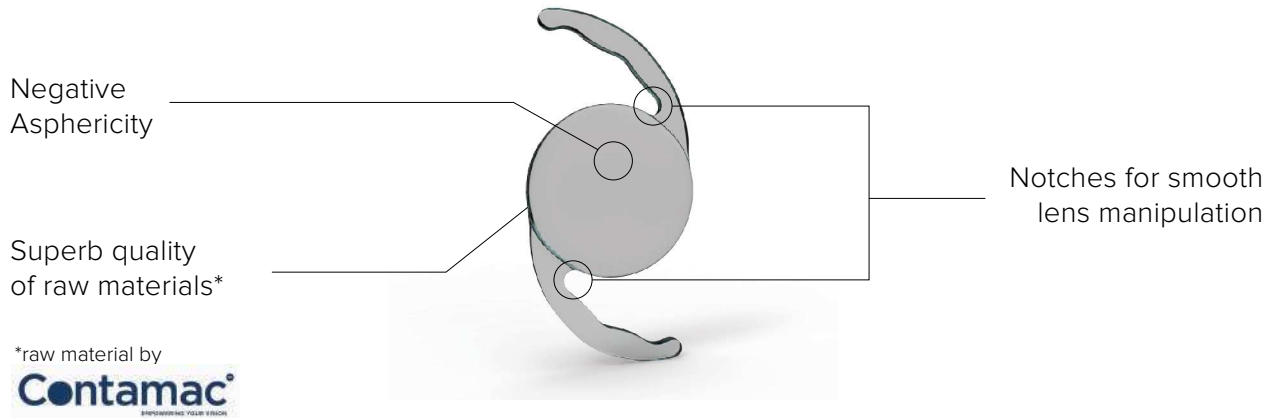

SDHB6130

Aspheric, *
360° Square Edge

*Also available in Spherical Design

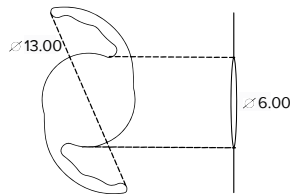

Optic Design: Biconvex
Optic Size: 6.00 mm
Overall Length: 13.00 mm
Haptic Angle: 0°

SDHB

Aspheric,
360° Square Edge

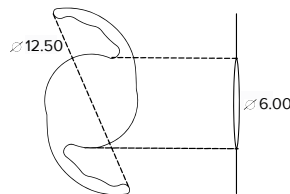

Optic Design: Biconvex
Optic Size: 6.00 mm
Overall Length: 12.50 mm
Haptic Angle: 0°

SDHBY ■

Aspheric,
360° Square Edge
Yellow, Blue Light Filtering

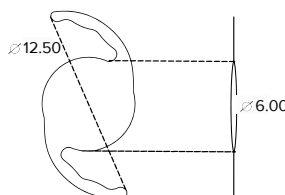

Optic Design: Biconvex
Optic Size: 6.00 mm
Overall Length: 12.50 mm
Haptic Angle: 0°

Hydrophilic

One-Piece Acrylic Foldable Intraocular Lens



- Exceptional biocompatibility and UV absorption
- High Resolution, Diopter Accuracy
- Easy lens manipulation
- Controlled surgical handling



SDA

Aspheric,
360° Square Edge,

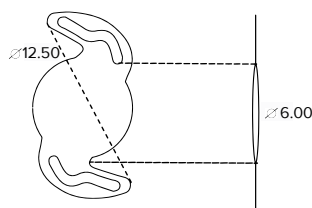

Optic Design: Biconvex
Optic Size: 6.00 mm
Overall Length: 12.50 mm
Haptic Angle: 5°

SDAC

Aspheric,
360° Square Edge

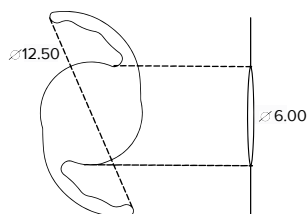

Optic Design: Biconvex
Optic Size: 6.00 mm
Overall Length: 12.50 mm
Haptic Angle: 5°

SDACY ■

Aspheric,
360° Square Edge
Yellow, Blue Light Filtering

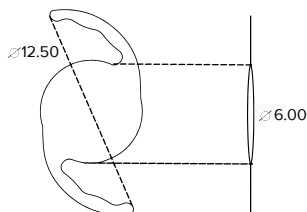

Optic Design: Biconvex
Optic Size: 6.00 mm
Overall Length: 12.50 mm
Haptic Angle: 5°

SDA4

Aspheric,
360° Square Edge

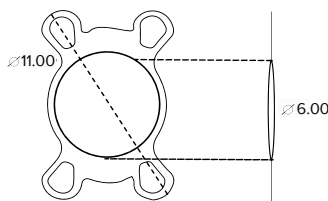

Optic Design: Biconvex
Optic Size: 6.00 mm
Overall Length: 11.00 mm
Haptic Angle: 5°

PMMA

- Clinical quality PMMA with UV absorber
- YAG laser compatible
- Proven Biocompatibility



ANTERIOR CHAMBER

SDANT

4 points of fixation

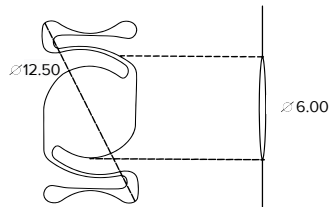

Optic Design: Equiconvex
 Optic Size: 6.00 mm
 Overall Length: 12.50 mm
 Haptic Design: S Loop

POSTERIOR CHAMBER

SDHS

2 Dialing holes

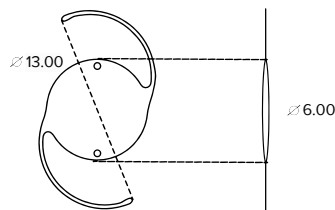

Optic Design: Equiconvex
 Optic Size: 6.00 mm
 Overall Length: 13.00 mm
 Haptic Design: C Loop

SDALP

2 Dialing holes

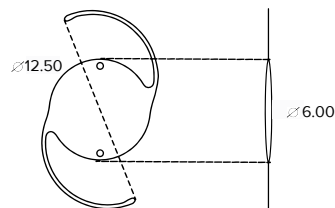

Optic Design: Equiconvex
 Optic Size: 6.00 mm
 Overall Length: 12.50 mm
 Haptic Design: C Loop